



Power Take Offs

Relation 1 : 1

Ref. TF4033AMP

ZF

S5-50 ; S5-90 ; S6-65 ; S6-66 ; S6-70 ; S6-75 ; S6-80 ; S6-90 ;
6S-800 ; 6S-1000 REINFORCED

To apply with Gear Pumps or with Piston Pumps

Main Dimensions

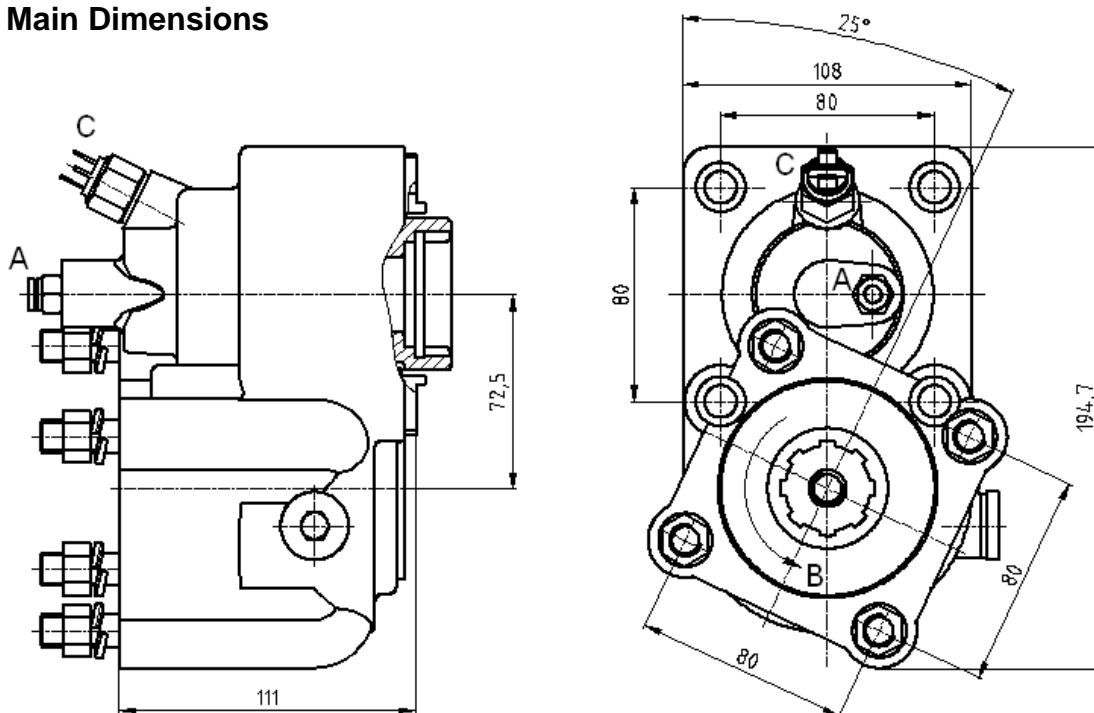

A – Air connection

B – Sense of rotation

C – Option: Electric sensor with mechanical driving Ref. TF4033AMPS or TF4033AMPC

(Dimensions in mm)

Main Data

Continuous Torque (Nm)	500
Intermittent Torque (Nm)	550
Power (at 1000 rpm)	69 cv / 51 kW
Mounting Position	Rear
Pump Rotation	Right Hand
Weight (kg)	11
PTO internal ratio	1:1
Indicative ratio from motor to PTO's output	
S5-50 / 5.30	.- 1 : 0.653
/ 5.50	.- 1 : 0.615
/ 6.20	.- 1 : 0.545
/ 6.61	.- 1 : 0.510
/ 6.61+GV80 / 5.30	High: .- 1 : 0.637 Normal: .- 1 : 0.510
/ 8.02	.- 1 : 0.422
/ 8.02+GV80 / 6.20	High: .-1 : 0.545 Normal: .- 1 : 0.421

CTI TF4033AMP 1211-2

ABER is constantly engaged in improving its products and, therefore, reserves itself the right to modify without any further notice the characteristics shown. The gear boxes are in constant change; therefore, ABER is not to be held responsible for any damage resulting from wrong application or application of outdated material.



ABER - Embraagens e Comandos Hidráulicos - A. B. LDA

Rua Francisco de Almeida, Nº 30 – Vila Nova da Telha – 4470 MAIA - Portugal

Telephone: +351.22.9438070 Fax: +351.22.9420823 e-mail: aber@aber.pt <http://www.aber.pt>



Power Take Offs

Relation 1 : 1

Ref. TF4033AMP

ZF

S5-50 ; S5-90 ; S6-65 ; S6-66 ; S6-70 ; S6-75 ; S6-80 ; S6-90 ;
6S-800 ; 6S-1000 REINFORCED

Engine to PTO ratio

S5-90 GPA	- 1 : 0.890
S6-65 / 6.37	- 1 : 0.650
/ 6.70	- 1 : 0.620
/ 7.00+GV70 / 7.67	High: - 1 : 0.456 Normal: - 1 : 0.365
/ 7.40	- 1 : 0.562
/ 7.52	- 1 : 0.555
/ 9.00	- 1 : 0.462
/ 7.97+GV80 / 6.70	High: - 1 : 0.620 Normal: - 1 : 0.525
/ 9.00+GV80 / 6.70	High: - 1 : 0.620 Normal: - 1 : 0.462
/ 9.00+GV80 / 7.52	High: - 1 : 0.554 Normal: - 1 : 0.462
S6-66 / 7.36-1.0	- 1 : 0.522
/ 9.06-1.0	- 1 : 0.416
S6-70 / 6.80	- 1 : 0.514
/ 6.80+GV70 / 5.71	High: - 1 : 0.612 Normal: - 1 : 0.514
/ 7.36	- 1 : 0.478
/ 7.92	- 1 : 0.441
/ 9.03	- 1 : 0.387
/ 9.59	- 1 : 0.365
S6-75 / 6.70+GV80 / 7.52	Normal: - 1 : 0.620 Low: - 1 : 0.554
S6-80 / 5.03	- 1 : 0.780
/ 5.66	- 1 : 0.740
/ 5.66+GV80 / 7.52	High: - 1 : 0.738 Normal: - 1 : 0.556
/ 6.10	- 1 : 0.688
/ 6.70	- 1 : 0.620
/ 6.70+GV80 / 5.30	High: - 1 : 0.787 Normal: - 1 : 0.620
/ 6.90	- 1 : 0.515
/ 7.35	- 1 : 0.552
/ 7.41	- 1 : 0.563
/ 7.53	- 1 : 0.555
/ 7.67	- 1 : 0.540
/ 7.67+GV80 / 6.70	High: - 1 : 0.622 Normal: - 1 : 0.543
/ 7.90	- 1 : 0.525
/ 9.00	- 1 : 0.460
/ 9.00+GV80 / 5.30	High: - 1 : 0.787 Normal: - 1 : 0.462
/ 9.00+GV80 / 7.48	High: - 1 : 0.562 Normal: - 1 : 0.462
/ 9.00+GV80 / 7.52	High: - 1 : 0.554 Normal: - 1 : 0.462
S6-90 / 5.67	- 1 : 0.750
/ 5.74	- 1 : 0.740
/ 6.37	- 1 : 0.740
/ 6.98	- 1 : 0.612
/ 7.03	- 1 : 0.603
/ 7.03+GV90 / 5.67	High: - 1 : 0.750 Normal: - 1 : 0.603
/ 7.03+GV90 / 5.74	High: - 1 : 0.735 Normal: - 1 : 0.600
/ 7.40	- 1 : 0.575
/ 9.01	- 1 : 0.470
/ 9.01+GV90 / 7.40	High: - 1 : 0.573 Normal: - 1 : 0.471
S5-90 GPA	- 1 : 0.890

CTI TF4033AMP 1211-2

ABER is constantly engaged in improving its products and, therefore, reserves itself the right to modify without any further notice the characteristics shown. The gear boxes are in constant change; therefore, ABER is not to be held responsible for any damage resulting from wrong application or application of outdated material.



ABER - Embraiaçgens e Comandos Hidráulicos - A. B. LDA

Rua Francisco de Almeida, Nº 30 – Vila Nova da Telha – 4470 MAIA - Portugal

Telephone: +351.22.9438070 Fax: +351.22.9420823 e-mail: aber@aber.pt <http://www.aber.pt>

2/2