



# ADAPTER KIT TO POWER TAKE OFFS

ZF

16-S-150 IT

Ref.VK4009S

## Main Dimensions

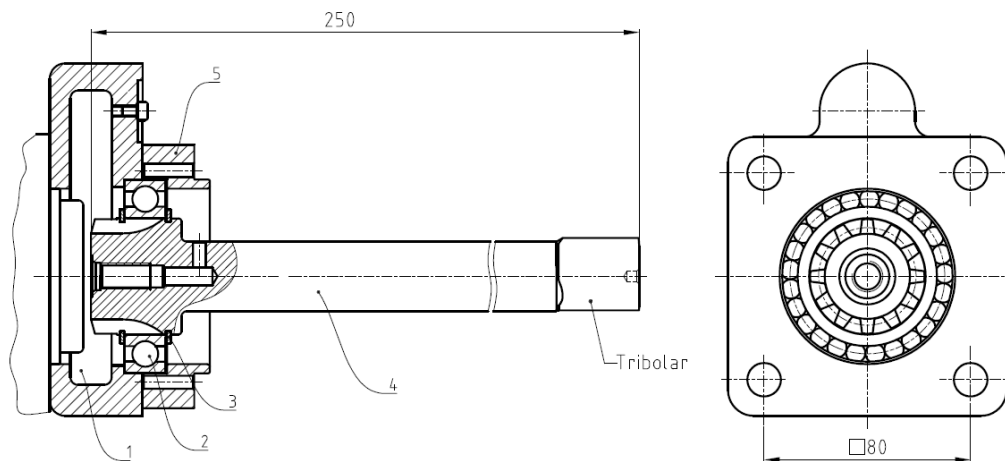

- 1 – Spacer
- 2 – Bearing
- 3 – Circlip
- 4 – Adapter shaft VK4009
- 5 – Spacer flange

(Dimensions in mm)

## Main Data

<b>Continuous Torque (Nm)</b>	<b>300</b>
<b>Intermittent Torque (Nm)</b>	<b>420</b>
<b>Power (at 1000 r.p.m)</b>	<b>42 H.P. / 32 Kw</b>
<b>Weight (Kg)</b>	<b>2.5</b>
<b>Engine-Kit adapter ratio</b>	

16-S-150/ 16.47	High: .- 1 : 0.920	Normal: .- 1 : 0.770
/ 13.80	High: .- 1 : 0.920	Normal: .- 1 : 0.770

### KIT Studs:

KIT VK4009S for PTO (ratio 1:1)

- 4 stud M12x170
- 4 nut M12
- 4 washer
- 2 jute ZF
- 1 jute IT

CTI VK4009S 0811- 1

ABER is constantly engaged in improving its products and, therefore, reserves itself the right to modify without any further notice the characteristics shown. The gear boxes are in constant change; therefore, ABER is not to be held responsible for any damage resulting from wrong application or application of outdated material.



**ABER - Embraiaçgens e Comandos Hidráulicos - A. B. LDA**

Rua Francisco de Almeida, Nº 30 – Vila Nova da Telha – 4470 MAIA - Portugal

Telephone: +351.22.9438070 Fax: +351.22.9420823 e-mail: [aber@aber.pt](mailto:aber@aber.pt) <http://www.aber.pt>



## ADAPTER KIT TO POWER TAKE OFFS

ZF

16-S-150 IT

Ref.VK4009AM

### Main Dimensions

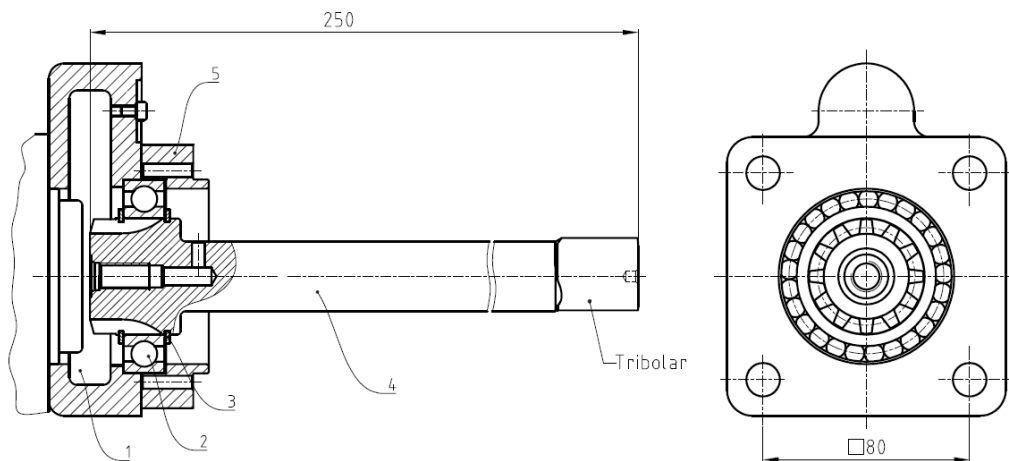

- 1 – Spacer
- 2 – Bearing
- 3 – Circlip
- 4 – Adapter shaft VK4009
- 5 – Spacer flange

(Dimensions in mm)

### Main Data

<b>Continuous Torque (Nm)</b>	<b>300</b>
<b>Intermittent Torque (Nm)</b>	<b>420</b>
<b>Power (at 1000 r.p.m)</b>	<b>42 H.P. / 32 Kw</b>
<b>Weight (Kg)</b>	<b>2.5</b>
<b>Engine-Kit adapter ratio</b>	

16-S-150/ 16.47	High: .- 1 : 0.920	Normal: .- 1 : 0.770
/ 13.80	High: .- 1 : 0.920	Normal: .- 1 : 0.770

#### KIT Studs:

KIT VK4008AM for PTO (ratio 1:1.32)

- 2 stud M12x135
- 2 stud M12x170
- 4 nut M12
- 4 washer
- 1 jute ZF
- 1 jute IT

CTI VK4009AM 0811-1

ABER is constantly engaged in improving its products and, therefore, reserves itself the right to modify without any further notice the characteristics shown. The gear boxes are in constant change; therefore, ABER is not to be held responsible for any damage resulting from wrong application or application of outdated material.



**ABER - Embraagens e Comandos Hidráulicos - A. B. LDA**

Rua Francisco de Almeida, Nº 30 – Vila Nova da Telha – 4470 MAIA - Portugal

Telephone: +351.22.9438070 Fax: +351.22.9420823 e-mail: [aber@aber.pt](mailto:aber@aber.pt) <http://www.aber.pt>

1/1